

Original Drag

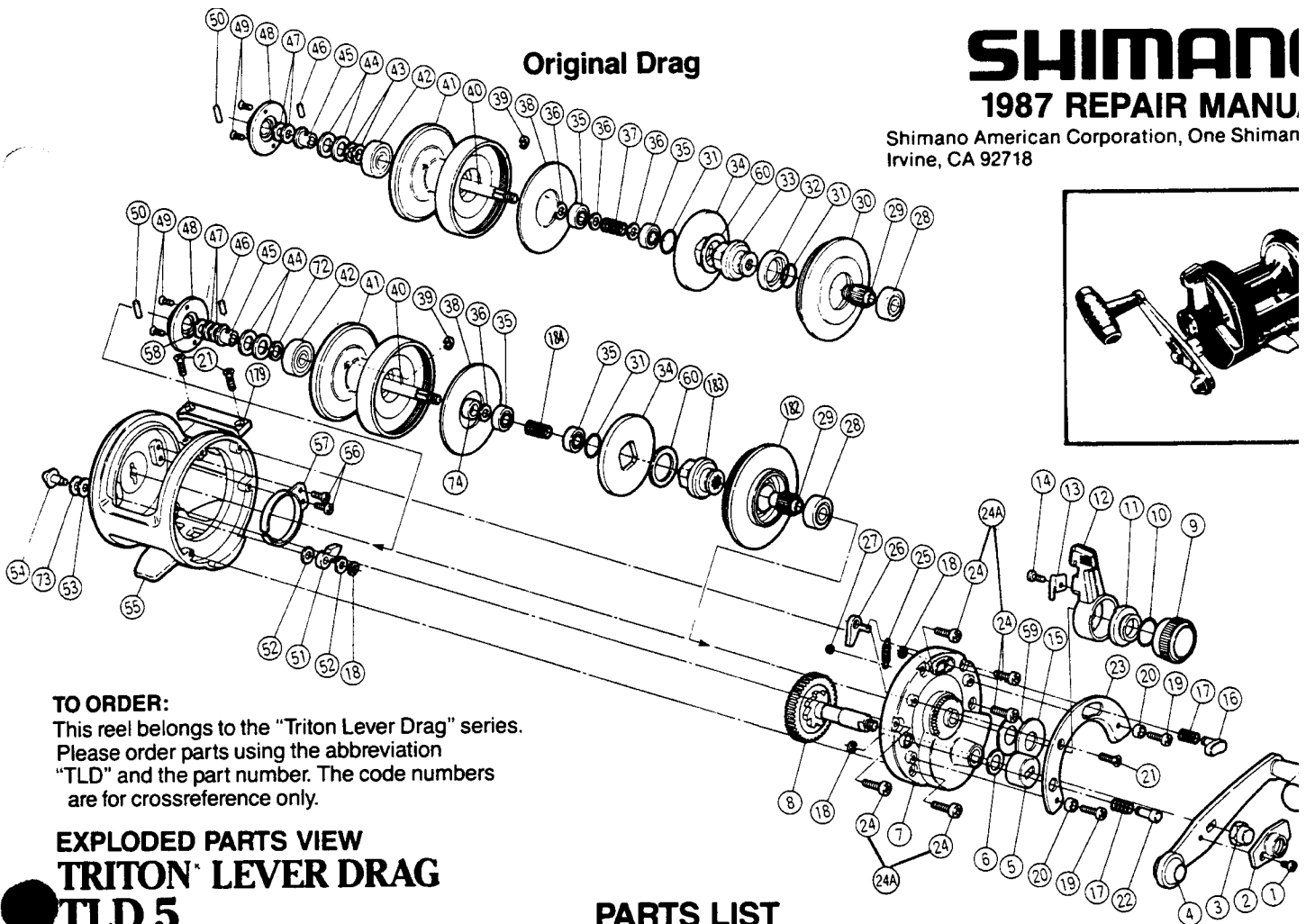

TO ORDER:

This reel belongs to the "Triton Lever Drag" series. Please order parts using the abbreviation "TLD" and the part number. The code numbers are for crossreference only.

EXPLODED PARTS VIEW TRITON™ LEVER DRAG TLD 5

PARTS LIST

PART #	CODE #	DESCRIPTION	PART #	CODE #	DESCRIPTION
1.	7-0014 30111S	Handle Lock Screw	36.	7-1764 09000S	Bearing Thrust Washer
2.	7-2124 06700S	Handle Lock	37.	7-1765 09000S	Pressure Release Spring
3.	7-2123 09000S	Handle Nut	38.	7-1766 09000S	Titanium Drag Washer
4.	6-2129 09000S	Handle	39.	7-0042 18400S	"C" Lock
5.	7-2171 09000S	Gear Shaft Shield	40.	7-1702 09000S	Main Shaft
6.	7-2111 06101S	Gear Shaft Thrust Washer	41.	7-1701 09000S	Spool
7.	6-2019 09000S	Side Plate	42.	7-0402 27302S	Ball Bearing (with oil)
8.	6-2109 09000S	Main Gear	43.	7-1754 09001S	Pre-Load Washer ****
9.	6-2089 09000S	Pre-Program Dial	44.	7-1755 09002S	Pre-Load Spring B
10.	7-0160 32300S	Body "O" Seal	45.	7-1762 09000S	Pre-Load Body
11.	7-2096 09000S	Lever Shaft Body	46.	7-1763 09000S	Cross Pin A
12.	7-2076 09000S	Drag Control Lever	47.	7-1738 09000S	Spacer A
13.	7-1445 09000S	Lever Click Spring	48.	6-1739 09000S	Click Gear
14.	7-0014 30220S	Click Spring Screw	49.	7-0012 00100S	Click Gear Screw
15.	7-2073 09000S	Lever Thrust Ring	50.	7-1760 09000S	Cross Pin B
16.	7-20B0 09000S	Strike Stop	51.	7-1414 09300S	Click Pawl
17.	7-20A2 09000S	Pressure Spring	52.	7-1471 09300S	Click Pawl Washer
18.	7-0040 30400S	"C" Lock	53.	7-1470 09300S	Click Button Washer A
19.	7-0011 30611S	Quadrant Anchor Bolt	54.	7-1468 09000S	Click Button
20.	7-2098 09000S	Bolt Shield	55.	6-15A9 09000S	One-Piece Body
21.	7-0012 30411S	Quadrant/Line Guard Screw	56.	7-0013 30140S	Click Spring Screw
22.	7-20A1 09000S	Free Spool Detent	57.	7-1415 09001S	Click Spring
23.	7-2090 09000S	Lever Quadrant	58.	7-1738 09001S	Spacer B
24.	7-0013 40571S	Side Plate Bolt	59.		Spacer
24A.		Side Plate Bolt (oversize)	60.	7-1755 09000S	Pre-Load Spring A
25.	7-1838 09000S	Dog Spring	72.	7-1754 0901 00	Pre-Load Washer A*
26.	7-1824 09000S	Dog	73.	7-1620 09300S	Click Button Washer B
27.	7-0050 01010S	Dog Spring Retainer	74.	7-1718 0900 00	Bushing**
28.	7-0402 27301S	Ball Bearing (with grease)	179.	7-15C7 090000	Line Guard*
29.	7-1706 09000S	Pinion Gear	182.	6-1779 0900 10	Cooling Shield (New)** ****
30.	7-1770 09000S	Cooling Shield	183.	6-1707 09000S	Pinion Guard (New)**
31.	7-1768 09000S	Seal Lock	184.	7-1765 0900 10	Pressure Release Spring (New)**
32.	7-1771 09000S	Shield Seal			
33.	7-1707 09000S	Pinion Guard			
34.	6-1769 09000S	Drag Plate			
35.	7-1517 10000S	Ball Bearing			

*Not present on early versions.

**No interchangeability with older parts.

***Identified by rubber seal around center hole.

****Original drag used two pieces of part #43, newer reels use 1 piece of 72 instead.